

HUDSON SERIES

USB 2.0 DIGITAL CAMERA LINEUP

CCD & CMOS



**FULL USB 2.0 COMPLIANT
RUGGED INDUSTRIAL DESIGN
PROGRESSIVE SCAN**



IMI HUDSON SERIES IMC-80U / 130UC / 300UC

Overview

The HUDSON SERIES' are full USB 2.0 compliant cameras featuring High Speed and High Resolution with external trigger and other industrial camera features..



Progressive image sensors provide high quality uncompressed images without the expense of frame grabbers. Every unit has passed our rigorous testing procedure to ensure reliability even in mission critical applications.

*USB 2.0 480MBPS WITH EXTERNAL TRIGGER
INDUSTRIAL RUGGED DESIGN*



Features

The fully USB 2.0 compliant HUDSON SERIES support high frame rates compared to other competitors. Data and power is supplied by a single cable connection delivering data at 480Mbps with all the user friendly features of as USB as plug & play. External hardware trigger is a standard for the HUDSON SERIES for industrial applications not suit for software trigger.

Uncompressed images in live streaming video and still images can be captured and processed and OEM applications can be developed easily with the bundled SDK, Demo Application, and Sample Codes.

Custom OEM form factors can be provided as well as board base camera modules for the HUDSON SERIES. Non Trigger models are available.



Applications

Digital Microscopy

Machine Vision

Semi-Con Inspection

Bar Code, OCR, OCV

F&B Inspection

Medical Application

For Sales Inquiry and Technical Support ▶



IMI TECHNOLOGY CO., LTD.

#2 Eun-Seok Bldg. 729-1 Yeoksam-Dong
Gangnam-Gu, Seoul 135-080, Korea

Tel : 82-2-539-6227 Fax : 82-2-539-6358

Email : w3master@imi-tech.com

Website : www.imi-tech.com

Dimension (in mm)

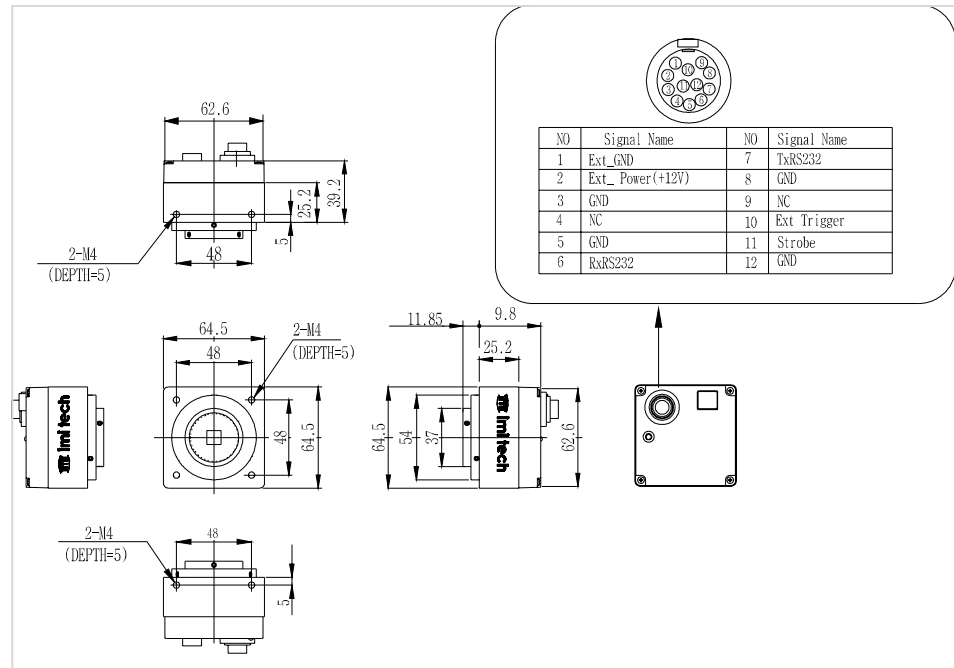

Specifications



Features	IMC-80U	IMC-130UC	IMB-300UC
Image Sensor	1/3" progressive scan CCD Sony ICX204AK	1/2" progressive scan CMOS (MT9T001)	1/2" progressive scan CMOS (MT9T001)
Cell Size(um)	4.65 x 4.65	5.2 x 5.2	3.2 x 3.2
Effective pixels	800,000 pixels	1,310,720 pixels	3,100,000 pixels
Max Resolution	1024x768	1280x1024	2048x1536
FPS at Max resolution	15(20 optional)	25	12
Power Consumption	2.3W	under 1.5W	under 1.5W
Data path (Color)	YUV(4:2:2) 16 bit	8 bit Raw RGB	8 bit Raw RGB
Shutter Speed	1/20,000sec~2sec	TBD	1/9,380sec~0.16sec
Gain Max	38 dB	TBD	TBD
Gamma	0.4~2.5	TBD	TBD
Signal to Noise ratio	56dB	43dB	43dB
Video Out Interface	USB2.0 (480Mbps)		
Lens Mount	C Mount	TBD	TBD
Regulations	FCC, CE, MIC, ROHS		
Operation Temperature	-5°C ~ 45°C		
Dimensions / Weight	64 (W) x 64 (H) x 60 (D) mm / approx. 300 gram	OEM DESIGN	OEM DESIGN
Supplied Accessories	Lens cover, Demo Application		

Note : Specification may subject to change without notice.